

APPROVED

[Signature]
 General Manager (Elect)
 EHT (Constn.) Circle
 OPTCL, Sambalpur

[Signature]
 Dy. Manager (Ele.)
 EHT Constn. Circle, OPTCL
 Sambalpur

[Signature] 17/08/19
 Deputy General Manager (Elect.)
 E.H.T. (Const) Division
 OPTCL, Barpali

CLIENT: ODISHA POWER TRANSMISSION CORPORATION LIMITED.

SAMPLE DRAWING FOR
 E-TENDER NOTICE NO.
 EHT(C)/01/2019-20

DRWN BY	SSD	TITLE :	DANGER BOARD			
CHKD BY						
APPD BY						
DRG NO. :	JDCIPLPTCL/CDBR02R2017	REV	00	SCALE :	NTS	SHEET NO. :

DANGER NOTICE PLATE

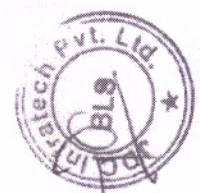

[Signature]
 Asst. General Manager (Elect.)
 EHT (C) Sub-Division
 OPTCL, Barpali

NOTES :-

- All dimensions are in mm
- Material M.S. (L.G) m. thick. 2mm thick or 16 gauge or more
- Front side of the plate shall be vitreous enamelled. White with letters. Figures and conventional skull and bones in signal red colour.
- Rear side of the plate shall also be enamelled.
- Bolt & nuts to be galvanized.

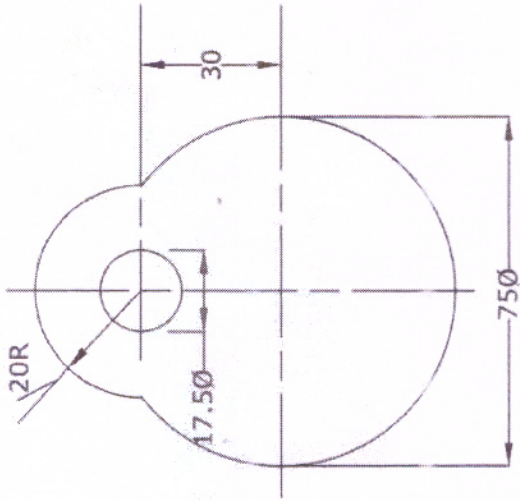

PHASE PLATE

17/08/12

General Manager (Elect.)
E.H.T. (Const.) Division
OPTCL, BARPALI

Asst. General Manager (Elect.)
E.H.T. (C) Sub-Division
OPTCL, BARPALI

NOTES :-

1. All dimensions are in mm otherwise specified.
2. One set consisting of 3 plate having red, blue and yellow colours shall be required for single circuit line
3. Two set each consisting of 3 plate having red, blue and yellow colours shall be required for double circuit line.
4. The plate shall be of minimum 3mm thick mild steel sheet. Front and back of the plate shall be enamelled. Front with colours as per Notes 1 & 2 & back enamelled black.

5. Bolt & Nut to be galvanised

(16 gauge or more)

APPROVED

Debaraj
General Manager (Elect.)
EHT (Constn.) Circle
OPTCL, Sambalpur

[Signature]
Dy. Manager (Elec.)
EHT Constn. Circle, OPTCL
Sambalpur

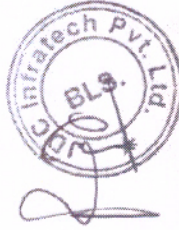

CLIENT:- ODISHA POWER TRANSMISSION CORPORATION LIMITED.

SAMPLE DRAWING FOR
TENDER NOTICE No.
EHT(C)/03/2019-20

DRWN BY	SSD	TITLE :-	PHASE PLATE
CHKD BY			
APPD BY			
DRG NO :- JDCIPLOPTCLGDB0302017	REV. 00	SCALE :- NTS	SHEET NO. :-

NOTES :-

1. ALL DIMENSION IN MM.
2. ALL HOLES ARE 17.5MMØ FOR 16MMØ BOLTS.
3. BLANK HOLES AT GATE ARE TO BE RECIVE BARBED WIRE.
4. STD. SPRING WASHER TO BE SUPPLIED WITH EACH BOLT AND SHALL CONFORM TO IS : 3983 (Type B) & 1573 SERVICE GRADE-4.
5. ALL STEEL SHALL BE HOT DIP GALVANISED. AS PER IS : 2829.
6. ALL STEEL SHALL CONFORM TO IS : 2062 GRADE A.
7. GALVANISED STEEL BARBED WIRE SHALL CONFORM TO A-1, IS : 278.
8. BOLT TO BE CONFORMING TO IS : 14394- 1998 (Gr. 5)
9. BOLT / NUT TO BE HOT DIP GALVANISED. AS PER IS : 1367 (P-13) - 1983.
10. BARBED WIRE SHALL BE GIVEN CHROMATING DIP AS PER PROCEDURE LAID DOWN IN IS : 1340
11. NOMINAL LENGTH OF BARBED WIRE SHALL BE WORKED OUT AS PER FOLLOWING FORMULAE.

$L = B + (X-3.5) \times 2 \times \tan \theta \times N$
 $B = B/B$ Width of CL for Normal Tower in Mtrs.
 $X =$ Height of Body Extn if any in Mtrs.
 $\theta =$ Tower Slope
APPROVED

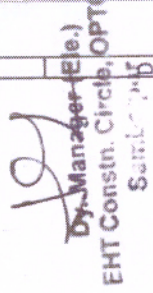
 Dy. Manager (Ele.)
 EHT Constn. Circle, OPTCL, Sambalpur

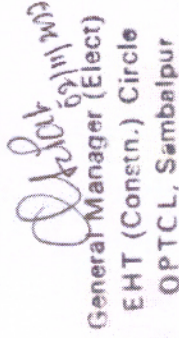

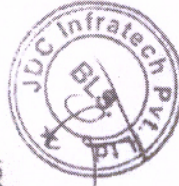
 General Manager (Elect)
 EHT (Constn.) Circle
 OPTCL, Sambalpur



CLIENT: ODISHA POWER TRANSMISSION CORPORATION LIMITED.

SAMPLE DRAWING FOR
 TENDER NOTICE NO.
 EHT(C) / 03 / 2019 - 20

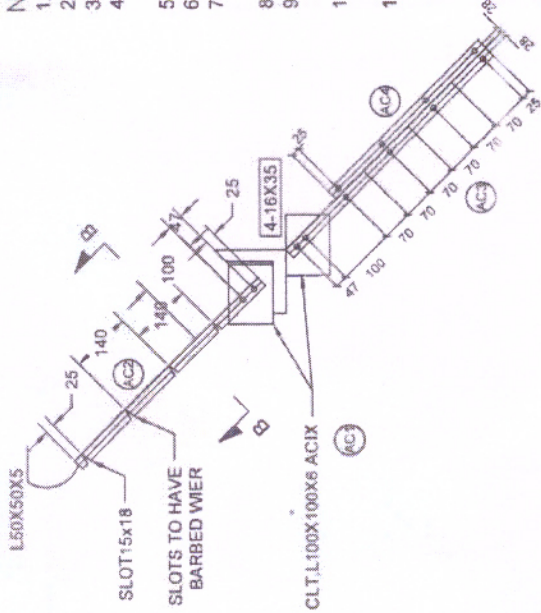
DRWN BY	SSD	TITLE :-
CHKD BY		ANTICLIMBING DEVICE
APPD BY		
DRG NO. :-	JDCIPL/OPTCL/GDB/0322017	REV. 00 SCALE :- NTS
	6	7
		8



GATE DETAILS PLAN ON A-A

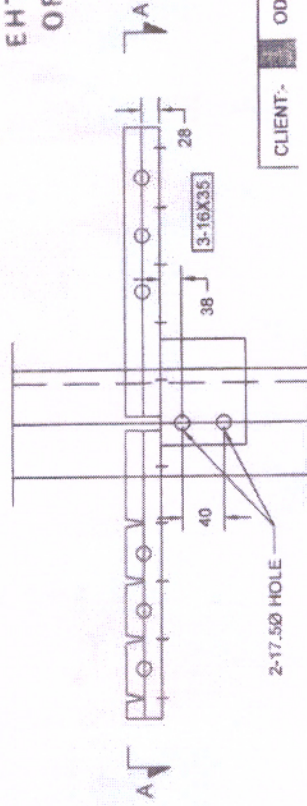

VIEW ON B-B

(METHOD & WARRPING BARBED WIRE)

17/08/19
 Deputy General Manager (Elect.)
 E.H.T. (Const) Division
 OPTCL, Sambalpur

BILL OF MATERIAL

MARK NO	SECTION	LENGTH (MM)	QTY NOS
AC1/AC1X	L 100 X 100 X 6	128	4+4=8
AC2	L 50 X 50 X 6	617	4
AC3	L 50 X 50 X 6	617	1
AC4	L 50 X 50 X 6	470	1
AC5	L 50 X 50 X 6	617	3

SL.NO.	LIST OF BOLTS & NUTS / TOWER			QTY
	STUB THICK. (mm)	SIZE	SIZE	
1	7-11	12-16	17-21 22-26	8
2	48	50	55 60	16
3	M-16 X 35LG			20

Asst. General Manager (Elect.)
 E.H.T. (C) Sub-Division
 OPTCL, Sambalpur

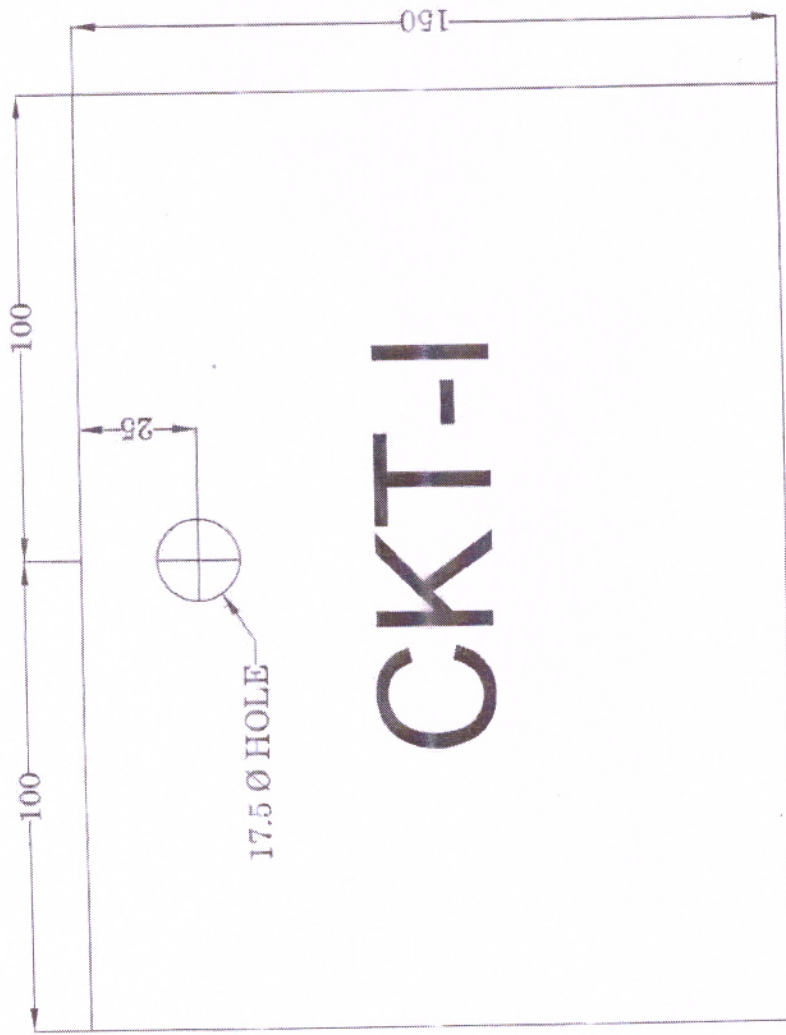

NOTES :-

1. All dimensions are in mm otherwise specified.
2. Lettering should be in red enamelled on white background.
3. Rear side of the plate shall be enamelled black.
4. One set consists of 2 such plates with markings 'I' & 'II' for double circuit tower only.
5. The material of the plate shall be of mild steel having minimum thickness $1\frac{1}{2}$ mm. or 16 gauge or more.

APPROVED

Subodh Kumar

General Manager (Elect)
EHT (Constn.) Circle
OPTCL, Sambalpur

[Signature]

Dy. Manager (Ele.)
EHT Constn. Circle, OPTCL
Sambalpur

CLIENT: ODISHA POWER TRANSMISSION CORPORATION LIMITED.

SAMPLE DRAWING FOR
TENDER NOTICE No.
EHT(C)/03/2019-20

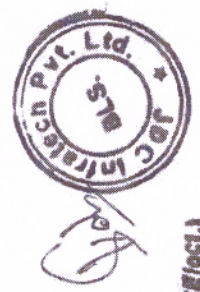

[Signature]
17/08/19
Deputy General Manager (Elect.)
E.H.T. (Const) Division
O.P.T.C.L., Balaasore

DRWN BY	SSD	TITLE :-
CHKD BY		DETAILS OF CIRCUIT PLATE (CIRCUIT-D)
APPD BY		
DRG NO. :-	JDCIPL/OPTCL/GDE/03/2017	REV. 00
		SCALE :- 1:1
		SHEET NO. :-

[Signature]
General Manager (Elect)
E.H.T. (Const) Division
Optcl, Sambalpur

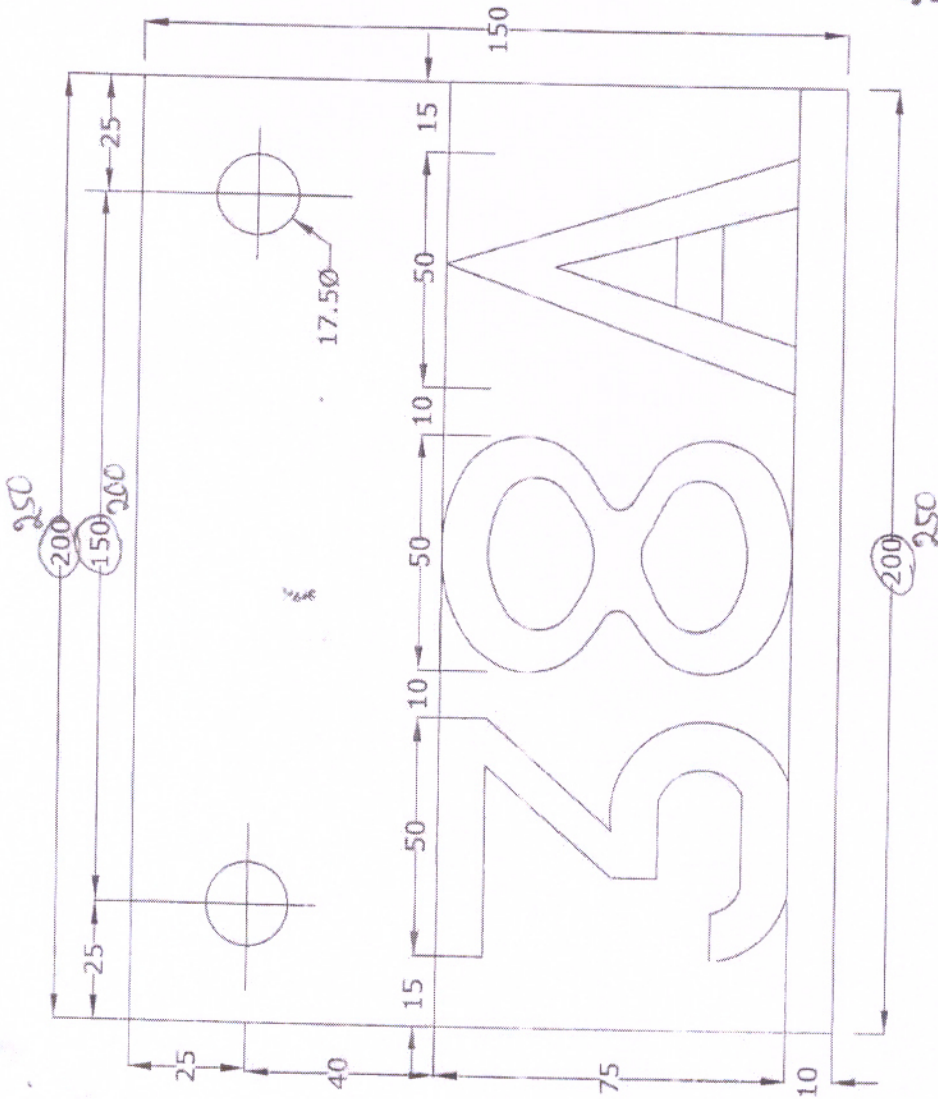

NUMBER PLATE

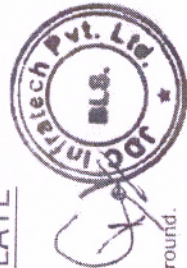

NOTES:-

1. All dimensions are in mm otherwise specified.
2. Lettering should be in red enamelled on white background.
3. The rear side of the plate shall be enamelled black.
4. The plate shall be of minimum 1.5 mm thick mild steel sheet.
5. For number plate, numbering shall be in sequence of tower numbers as per specification.
6. 'CS' represents first letter of starting and ending place of line respectively.

APPROVED

[Signature]
 General Manager (Elect)
 EHT (Constn.) Circle
 OPTCL, Sambalpur

[Signature]
 Dy. Manager (Ele.)
 EHT Constn. Circle, OPTCL
 Sambalpur

[Signature] 17/05/17

[Signature]
 Junior Manager (Elect)
 E.H.T. (C), Sub-Division
 OPTCL, Barpali

[Signature]
 Deputy General Manager (Elect.)
 E.H.T. (Const) Division
 O.P.T.C.L., Bargaoti

CLIENT: ODISHA POWER TRANSMISSION CORPORATION LIMITED

SAMPLE DRAWING FOR
 Ø-TENDER NOTICE No.
 EHT(C) / 05 / 2019 -28

URWN BY	SSD	TITLE :-
CHKD BY		
APPD BY		
FIG. NO. :-		NUMBER PLATE

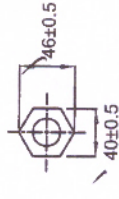
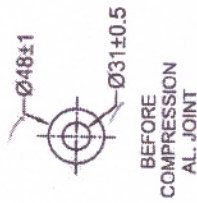
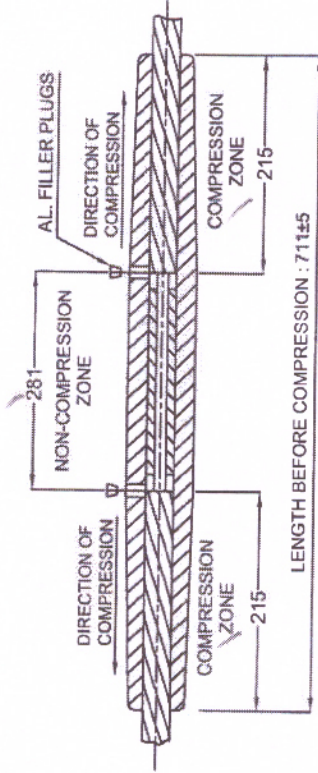

AFTER COMPRESSION AL. JOINT

APPROVED

CGM (Construction)
OPTCL, Bhubaneswar

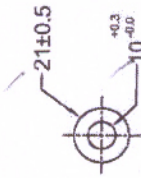

BEFORE COMPRESSION ST. JOINT

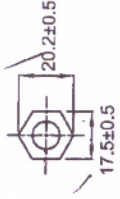

AFTER COMPRESSION ST. JOINT

RECOMMENDED

Sr. General Manager (Elect.)
O/o CGM (C), JICA Cell
OPTCL, Bhubaneswar

CHECKED

TECHNICAL DATA :-

- MATERIAL -
A) ALUMINIUM JOINT - ALUMINIUM EXTRUDED TUBE, 19500, IS:793
B) STEEL JOINT - MILD STEEL, Fe-410, IS:2062, H.D.G. AS PER IS:2633
SLIP STRENGTH - NOT LESS THAN 95% OF UTS OF ACSR ZEBRA
- ELECTRICAL DC RESISTANCE- LESS THAN 75% OF THAT OF EQUAL LENGTH OF ACSR ZEBRA
- GOVERNING STANDARD - IS:2121 PART-2
- ALL DIMENSIONS ARE IN MM
- GENERAL TOLERANCE - $\pm 3\%$ UNLESS OTHERWISE SPECIFIED

		ODISHA POWER TRANSMISSION CORPORATION LIMITED (A GOVERNMENT OF ODISHA UNDERTAKING)	
PROJECT : 220/33KV AIS S/S & 220KV DC TTL LINE - DEOGARH & LEHRIPADA 132/33KV AIS S/S & 132KV DC LINE - LAKHANTPUR & THUAPALLI		CONTRACT No. :- 01/2017-18 (JICA) Dated 07.06.2017	
EMPLOYER :		CONTRACTOR :-	
Sr. General Manager (Elect.) O/o CGM (C), JICA Cell OPTCL, Bhubaneswar		ANGELIQUE INTERNATIONAL LIMITED PROJECT ENGINEERING, PROCUREMENT AND CONSTRUCTION COMPANY	
CHECKED Manager (Elect.) O/o CGM (C), JICA Cell OPTCL, Bhubaneswar		DRAWN :- S. M. S.K.DAS A. MONDAL	
RECOMMENDED Sr. General Manager (Elect.) O/o CGM (C), JICA Cell OPTCL, Bhubaneswar		MID SPAN COMPRESSION JOINT FOR ACSR ZEBRA	
DRG NO. JTL-MSC/JZ-010		DATE:- 24.07.18 REV.-02 SCALE:-NTS	

Sample drawing for tender Notice No. EATC/17/01/2019-20

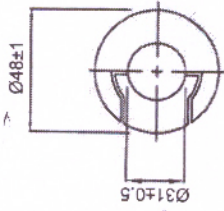

BEFORE COMPRESSION

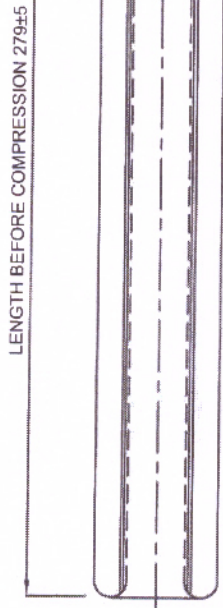

LENGTH BEFORE COMPRESSION 279±5

ALUMINIUM SLEEVE

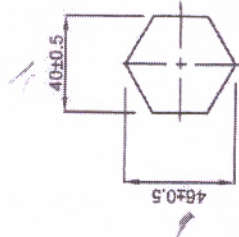

AFTER COMPRESSION

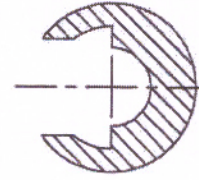

LOWER SLIDE

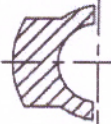

UPPER SLIDE

Akm



RECOMMENDED

[Signature]
Sr. General Manager (Elect.)
O/o CGM (C), JICA Cell
OPTCL, Bhubaneswar

APPROVED

[Signature]
CGM (CONSTRUCTION)
OPTCL, Bhubaneswar

CHECKED

[Signature]
Manager (Elect.)
O/o CGM (C), JICA Cell
OPTCL, Bhubaneswar

TECHNICAL DATA :-

1. MATERIAL - EXTRUDED ALUMINIUM TUBE 19500, IS:733
2. GOVERNING STANDARD - IS:2121 PART-2
3. ALL DIMENSION ARE IN MM
4. GENERAL TOLERANCE ±3% UNLESS OTHERWISE SPECIFIED
5. IDENTIFICATION MARK : JAINCO
6. MIN. SLIP STRENGTH - 95% OF UTS OF ACSR ZEBRA (i.e. 123.8 KN)

EMPLOYER : ODISHA POWER TRANSMISSION CORPORATION LIMITED (A GOVERNMENT OF ODISHA UNDERTAKING)	
PROJECT : 220/33KV AIS S/S & 220KV DC T/L LINE - DEOGARH & LEHRIPADA 132/33KV AIS S/S & 132KV D/LINE - LAKHANPUR & THUAPALLI	
CONTRACT No. :- 01/2017-18 (JICA) Dated 07.06.2017	
CONTRACTOR :- ANGELIQUE INTERNATIONAL LIMITED PROJECT ENGINEERING, PROCUREMENT AND CONSTRUCTION COMPANY	
REPAIR SLEEVE FOR ACSR ZEBRA	DRAWN :- S. M. S.K.DAS
DATE :- 24.07.18	REV:-02
DRG NO. JTL-RSZ-018	SCALE:-NTS
FILE DETAIL - TRANSMISSION DRG, PROJECT/PT/132/11/REPAIR SLEEVE FOR ACSR ZEBRA	

Sample drawing for tender Notice No. EHTC/7/101/2019-20

47